

Diaphragm valve

514/515

Georg Fischer



The manually actuated diaphragm valve from GF ensures a safe and precise setting of the liquid flow and shuts off the passage completely, if required. A plastic housing nut ensures a corrosion-free connection to the housing of the valve.

The diaphragm separates the moving parts from the medium to be transported. A constricted passage ensures an accelerated linear flow.

As standard the GF diaphragm valve is equipped with a lockable hand wheel and a two-colour position indicator. The 514 Series has a nut fitting, the 515 Series a glue fitting.

APPLICATION

Chemical industry (fertiliser units), water treatment systems, foodstuffs industry

CHARACTERISTICS

- ✓ Sleek housing
- ✓ Resistant to corrosion and chemicals
- ✓ Homogeneous flow even with temperature fluctuations
- ✓ Uniform surface pressure
- ✓ Equipped with two-colour position indicator
- ✓ Lockable hand wheel
- ✓ Short installation length

TECHNICAL DATA

	Type 514
	Type 515
Connection	: bush with screw nut : glue fitting (wedge end)
Diameter	: 20 - 63 mm : 25 - 63mm
Pressure class	: PN10 : PN10
Material	: PVC-U (housing) PVC-U (housing) : EPDM (diaphragm) EPDM (diaphragm)

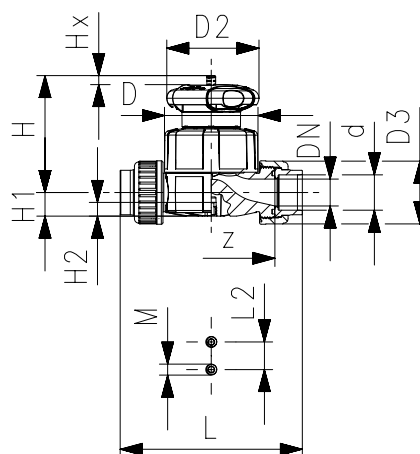

Sizes and Kv-Values

Diameter	DN	D	D2	D3	H	H1	H2	L	L2	M	z	Hx	PN	Kv value
(mm)	(mm)	(mm)	(mm)	(mm)	(mm)	(mm)	(mm)	(mm)	(mm)	(mm)	(mm)	(mm)	(bar)	(l/min)
20	15	65	65	43	73	14	12	128	25	M6	96	7	10	125
25	20	80	65	51	81	18	12	152	25	M6	114	10	10	271
32	25	88	87	58	107	22	12	166	25	M6	122	13	10	481
40	32	101	87	72	115	26	15	192	45	M8	140	15	10	759
50	40	117	135	83	148	32	15	222	45	M8	160	19	10	1263
63	50	144	135	100	166	39	15	266	45	M8	190	25	10	1728

INSTALLATION & MAINTENANCE

- ✓ The diaphragm valve can be installed both horizontally and vertically.