

# Y Filter

FIP



The FIP Y-Filter screens and collects solid particles from the water flow by means of a filter screen. The screen is easy to remove for maintenance.

## CHARACTERISTICS

- ✓ Filtration from 300 to 900 micron
- ✓ Easy to clean
- ✓ Transparent or grey PVC housing

## TECHNICAL DATA

Models	: RVUIT (double nut: adhesive insert, transparent) : RVUIV (double nut: adhesive insert, grey) : RVIT (adhesive insert, transparent) : RVIV (adhesive insert, grey)
Diameter	: 16 - 110 mm
Pressure class	: PN16
Max. pressure at 20°C	: PN16 (dia. 16 - 63 mm), PN10 (dia. 75 mm), PN6 (dia. 90 - 110 mm)
Dirt trap material	: PVC or transparent PVC (housing) : PVC (strainer) : EPDM (seal), optionally FPM
Connection	: bush with screw nut (dia. 16-63 mm), glue fitting (dia. 75 - 110 mm) PVC screen size : 1.5 mm ~ 500 micron (standard)
Sizes (optional)	: 1 mm ~ 300 micron : 2 mm ~ 600 micron : 2.5 mm ~ 900 micron : 0.7 mm ~ 370 micron (stainless steel strainer)

## Kv-value (l/min)

Diameter (mm)	16	20	25	32	40	50	63	75	90	110
Kv-value	22	40	70	103	188	255	410	650	1050	1700

## Parts list and drawing

No.	Description
1	Body
2	Screen
3	Bonnet
4	Screen support housing
5	O-Ring seal
6	Retaining ring

No.	Description
7	Lock nut
8	Split ring
9	Socket seal O-Ring
10	End connector
11	Union-nut

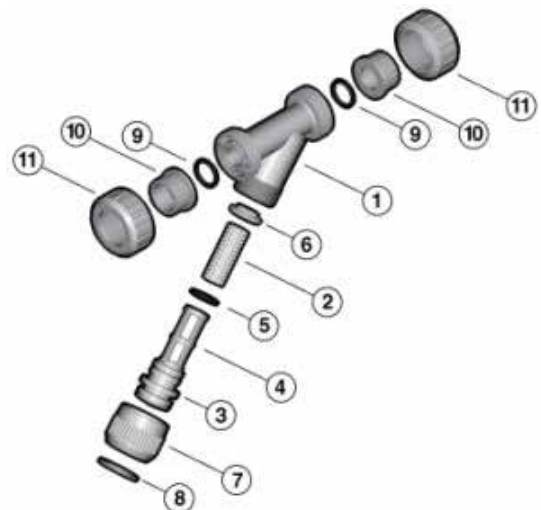

## INSTALLATION & MAINTENANCE

- ✓ Install the dirt trap with the arrow in the direction of the liquid flow and the dirt trap facing downwards.

# Suction strainer type 050

Georg Fischer



The GF strainer prevents coarse contaminants entering the intake line and can thus prevent damage occurring to the pump installation. The strainer is installed by means of a glue joint and has a sturdy construction.

## CHARACTERISTICS

- ✓ Different diameters
- ✓ Glue joint
- ✓ Available in 2 models

## TECHNICAL DATA

Diameter	: Ø20 - 63 mm (spherical shape) : Ø75 - 110 mm (cylinder shape)
Material	: PVC-U
Connection	: glue joint
Mesh width	: 1.5 - 6 mm

### Kv-value 20 - 63 mm (l/min)

Diameter (mm)	20	25	32	40	50	63
Kv-value	105	228	390	563	813	1590

### Kv-value 75 - 110 mm (l/min)

Diameter (mm)	75	90	110
Kv-value	9.640	14.790	15.213